

STRUCTURE A:
GROUND FLOOR PLAN
SCALE 1:100

MANGAUNG METRO MUNICIPALITY
ECONOMIC DEVELOPMENT AND PLANNING DIRECTORATE
LAND USE CONTROL SUBDIRECTORATE
Recommended for approval
Ntshikela
Building Control Officer / Designer
This application has been approved in terms of
Section 2(1)(a) of Act 103 of 1977, subject to the
conditions in the attached letter of recommendation.
GENERAL MANAGER: LAND USE CONTROL DATE 10/02/2011
PLAN NO.: 1289/2010-2011

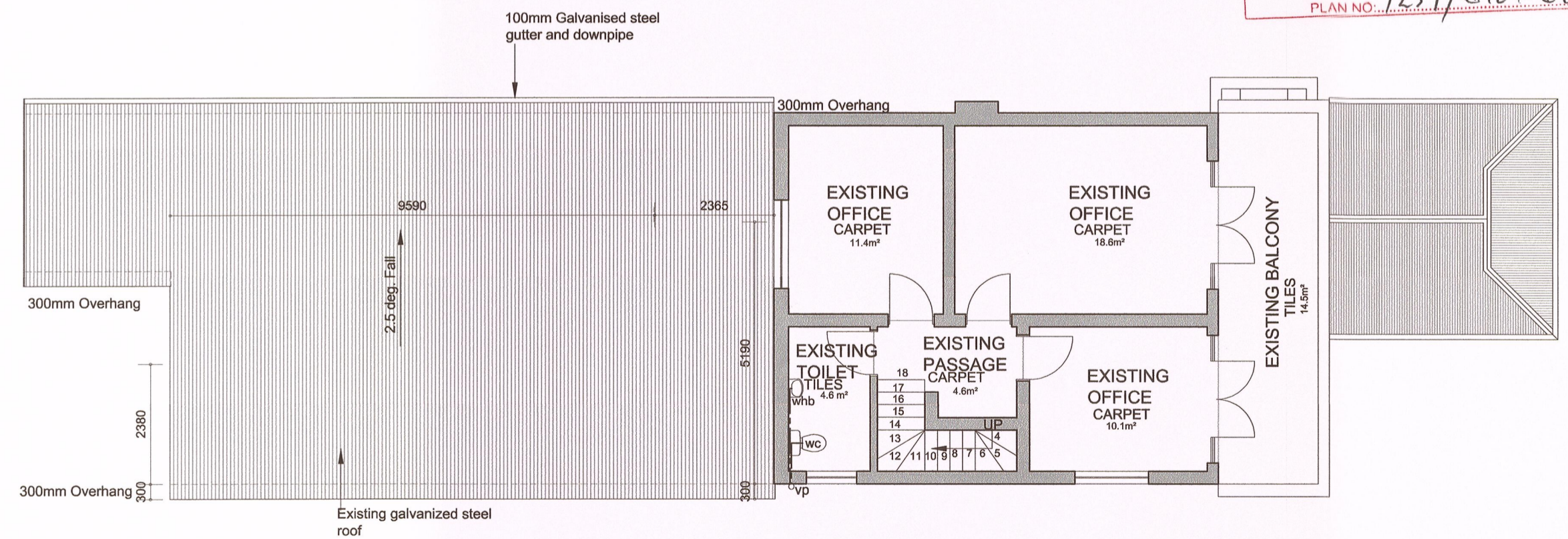

STRUCTURE A:
FIRST FLOOR PLAN
SCALE 1:100

[Handwritten signature]

NOTES

All dimensions on the drawings must be verified against the existing site conditions before the commencement of any work.
Drawings may not be scaled.
The vertical dimensions of brickwork are based on multiple centre lines of 85mm and the contractor must set out brickwork accordingly.
The contractor is responsible for site inspections by the building inspectors of the local authorities.
Except where otherwise indicated all given levels are unfinished levels.
The copyright of this drawing vests in the architect unless otherwise indicated.
All work must be done according to the South African Bureau of Standard's code of practice SANS 10400-2010.

No.	REVISION	DATE	APPROVED

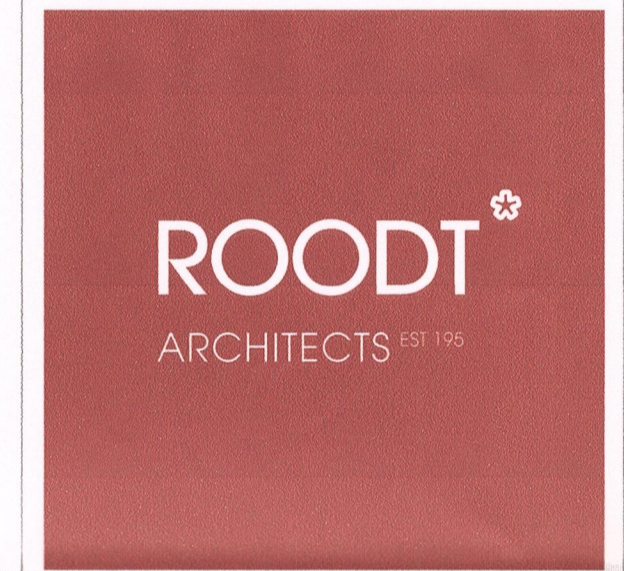

ARCHITECTS EST 1952
ARCHITECTURE, URBAN DESIGN, URBAN PLANNING, INTERIOR DESIGN
ENVIRONMENTAL MANAGEMENT & HERITAGE CONSULTING
7 RAY CHAMPION AVENUE, LILYVALE, BLOEMFONTEIN, 9301
PO BOX 28278, DANHOF, 9310
TEL: 051 406 2100, FAX: 051 406 2101
info@roodtarchitects.co.za, www.roodtarchitects.co.za

PAN CYPRIOT CC. CLIENT

RECORD DRAWINGS OF ALL BUILDINGS ON ERF 267, PRES. STEYN STREET 47, WESTDENE BLOEMFONTEIN PROJECT

GROUND AND FIRST FLOOR PLAN DRAWING

DESIGN	DATE
N/A	
DRAWN	DATE
KG	25/01/2018
APPROVED	DATE
SCALE	ISSUED
1:100	12/02/2018
DRAWING STATUS	DRAWING NO.
RECORD DRAWINGS	1074_4/W1/02