

AREA MEASUREMENTS AND CALCULATIONS		PARKING CALCULATIONS AREA MEASUREMENTS AND CALCULATIONS		PARKING CALCULATIONS AREA MEASUREMENTS AND CALCULATIONS	
6	New anchor Retail area 612m <sup>2</sup> GLA	6	parkings/100m <sup>2</sup> GLA	6	parkings/100m <sup>2</sup> GLA
6	Existing anchor Retail area 316m <sup>2</sup> GLA	6	parkings/100m <sup>2</sup> GLA	6	parkings/100m <sup>2</sup> GLA
		54	TOTAL PARKINGS NEEDED	54	TOTAL PARKINGS PROVIDED
				23	1,75 parkings/apartment
				132	
				134	

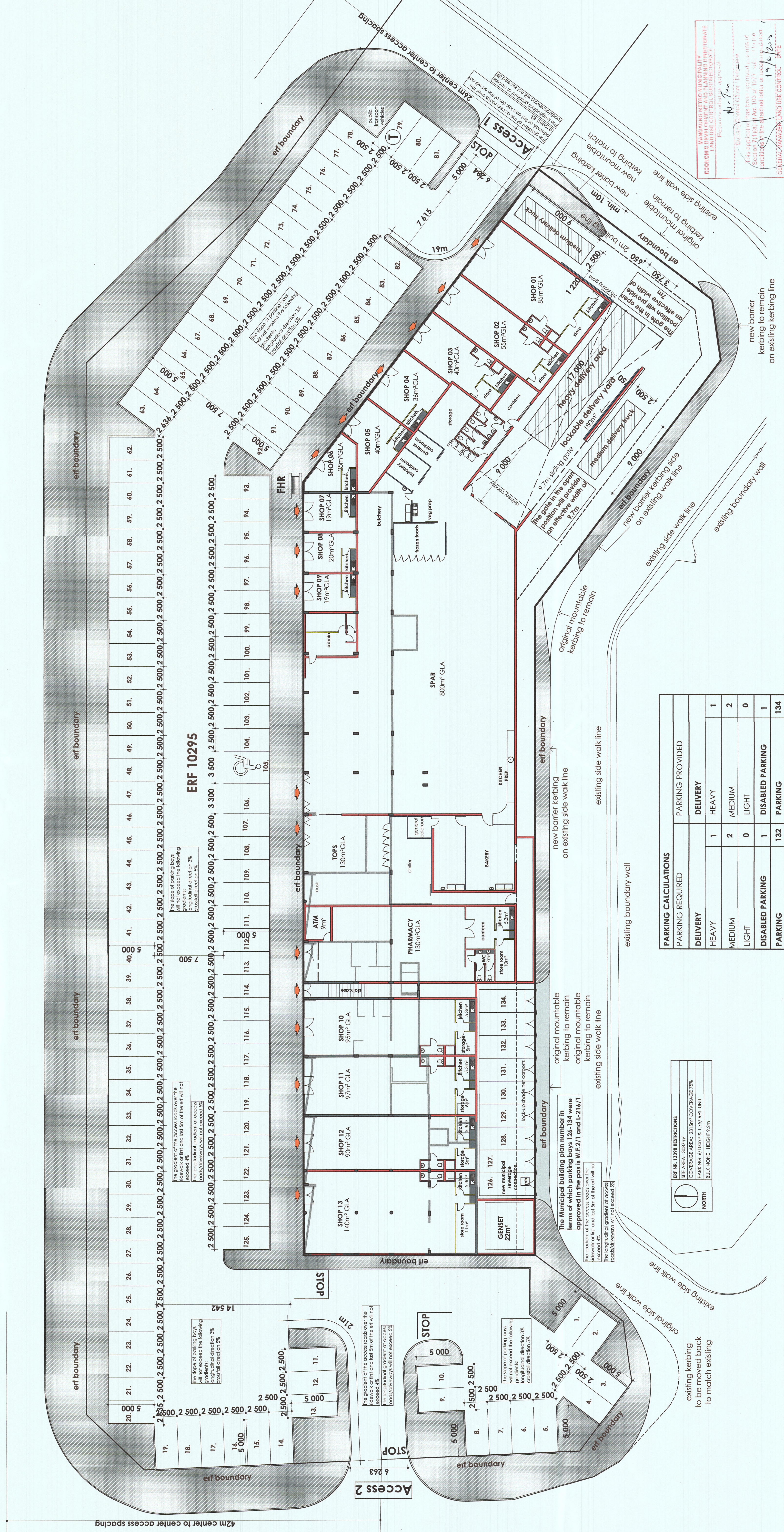

PARKING CALCULATIONS		PARKING PROVIDED	
DELIVERY	HEAVY	1	DELIVERY
MEDIUM	2	HEAVY	1
LIGHT	0	MEDIUM	2
DISABLED PARKING	1	LIGHT	0
PARKING	132	DISABLED PARKING	1
		PARKING	134

PARKING CALCULATIONS		PARKING REQUIRED	
DELIVERY	HEAVY	1	DELIVERY
MEDIUM	2	HEAVY	1
LIGHT	0	MEDIUM	2
DISABLED PARKING	1	LIGHT	0
PARKING	132	DISABLED PARKING	1
		PARKING	134

**ARCHITECT**

**p+o+c architects**  
 P.O. Box 11317  
 25 Store Avenue  
 Greenwood  
 2146  
 Tel: 021 231 4231 Fax: 021 231 4232  
 email: pover@pover.com  
 website: www.pover.com

**CLIENT**

**MESSRS. KLEO TRUST**

**DRAWING**

**p184.SDP6.01**

**PROJECT**

**SHUMAN'S BUILDINGS**  
**ERF 13398**  
**JASMYN AVENUE**  
**GARDENIAPARK**  
**BLOEMFONTEIN**

**DRAWING**

**SITE DEVELOPMENT PLAN**

**SCALE**

**1: 50**  
**100**  
**200**  
**300**

**DATE**

**MAR 2018**

**NOTES**

Except where otherwise indicated all given levels are unfinished levels.

Die besittings van hierdie tekeninge behoort by die argitek lessie indien versoek.

The copyright of this drawing rests in the architect unless otherwise indicated.

Alle tekeninge moet volgens die Suid-Afrikaanse Buro vir Standaarde en Meetkunde (SABS) 0400:1990.

All work must be done according to the South African Bureau of Standards code of practice 0400:1990.

Engels is die hoof taal van hierdie tekening. Die oorspronklike tekening is in Engels.

Any deviations or contradictions must immediately be communicated to the architect for resolution.

Voorskrifte van alle materiale wat op tekening geteken word moet aan die argitek gelewer word vir goedkeuring voordat enige materiaal bestel of gebruik word.

Any deviations or contradictions must immediately be communicated to the architect for resolution.

Voorskrifte van alle materiale wat op tekening geteken word moet aan die argitek gelewer word vir goedkeuring voordat enige materiaal bestel of gebruik word.